

ENQUIRY-DUE DATE EXTENSION

To

Sub: Inviting offer for the Procurement of Indoor, Single phase Resin cast Potential Transformer for 11KV along with HT Fuse – Reg.,

Ref: Our Enquiry No: U-092/MMC/2020-21/1283. Date: 01.10.2020.

QUOTATION TO BE:

Submitted on or before – 11.11.2020 @ 5 PM	Opened on - 12.11.2020 @ 11 AM
Kept valid for 3 months from the date of opening	Submitted in ONE part.

Sealed quotations are invited for the supply of Indoor, Single phase Resin cast Potential Transformer for 11KV along with HT Fuse as per Specification & Dimensional drawing enclosed and as per the terms and conditions mentioned therein.

General Terms and conditions:

1. The rate quoted should be firm, inclusive of GST, freight and all other charges as admissible.
2. Applicable other charges, if any should be clearly mentioned. If not mentioned, it will be presumed that the rate quoted is inclusive of all other charges.
3. The materials should be original and as per the specification and dimensional drawing only.
4. The materials should be directly supplied to the PPCL site, T. R. Pattinam, Karaikal-609 606, on door delivery basis.
5. **Payment: 100%** Payment will be made within 30 days from the date of receipt of your invoice after receipt of materials in good condition. The **bill in triplicate** along with **Advance stamp fixed and signed receipt** should be sent to the undersigned for effecting payment.
6. The delivery period and mode of dispatch should be clearly specified.
7. The supplier should produce necessary test, guarantee certificates for the Indoor, Single phase Resin cast Potential Transformer for 11KV along with HT Fuse at the time of delivery
8. Any loss or damage during transit to site should be made good by the supplier free of charge provided the same is reported within 15 days of the arrival of material at site.
9. **Validity:** Your offer should be valid for 90 days from the date of tender opening.
10. Sealed quotation should be superscripted as "QUOTATION/ENQUIRY NO. U-092 for the supply of Indoor, Single phase Resin cast Potential Transformer for 11KV along with HT Fuse". And to be sent to **The Executive Engineer (Mech.), Puducherry Power Corporation Limited, T.R.Pattinam, Karaikal-609606.**
11. Quotation through e-mail or any other mode will not be accepted.
12. Our **GSTIN No.34AAACP6507E1ZS** is registered with Commercial Taxes Department, Puducherry. The GST number of the agency should be provided in the offer.
13. The undersigned reserves all rights to accept/reject the quotation without assigning any reasons thereof.
14. **If already submitted the offer earlier for the enquiry reference cited above, please make a note of the due date extension.**

26/10/2020
EXECUTIVE ENGINEER (MECH) PLANT

**PUDUCHERRY POWER CORPORATION LIMITED**

(A GOVERNMENT OF PUDUCHERRY UNDERTAKING)

PROJECT OFFICE, T.R. PATTINAM 609 606, KARAIKAL.

Phone: 04368-233060

Email: ppclmmc@gmail.com

Telefax: 04368-233355.

Ref. No: U-092/MMC/2020-21/1494

GSTIN No.34AAACP6507E1ZS

Dt.26.10.2020.

ENQUIRY PAGE NO. 2

Description	Qty Reqd.	Unit Rate (Rs.)	Total Amount (Rs.)
Indoor ,Single phase Resin cast Potential Transformer for 11KV bus along with HT Fuse Ratio - $\frac{11000 \text{ V}}{110 \text{ V}} / \sqrt{3}$ Burden - 100V A, Class: 0.2/ 3P Voltage Factor : 1.2 Continuous & 1.9 for 8 hours Phase - Single, Frequency: 50Hz Insulation Level: 12/28/75 kV Conforms to IS 3156/1992 Insulation Class: B System: Earthed HT Fuse Rating: 11kV, 3A with a set of fuse clamps per PT. Type: VTF-11, Length 19 cms Make: AE/Crompton/Pragati As per the Enclosed Dimensional drawing	03 No's		
		Add: P&F Charges	
		Add: Freight Charges	
		Add: GST@ %	
		Total	

Commercial Terms and Condition:

Sl.No	Details	Terms in Tender	Terms Accepted by the Party
1	Price Quoted	F.O.R. PPCL, Site	
2	Payment Terms	Within 30 days after delivery of the materials.	
3	Validity	90 Days from date of opening of Tender	
4	Delivery Period	Vendor to specify	
5	Acceptance of All the Terms and Condition of the Enquiry	To be Accepted	

Signature with Seal of the Party

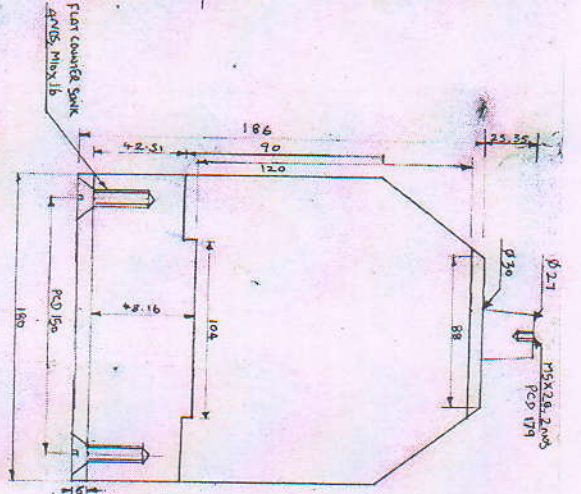
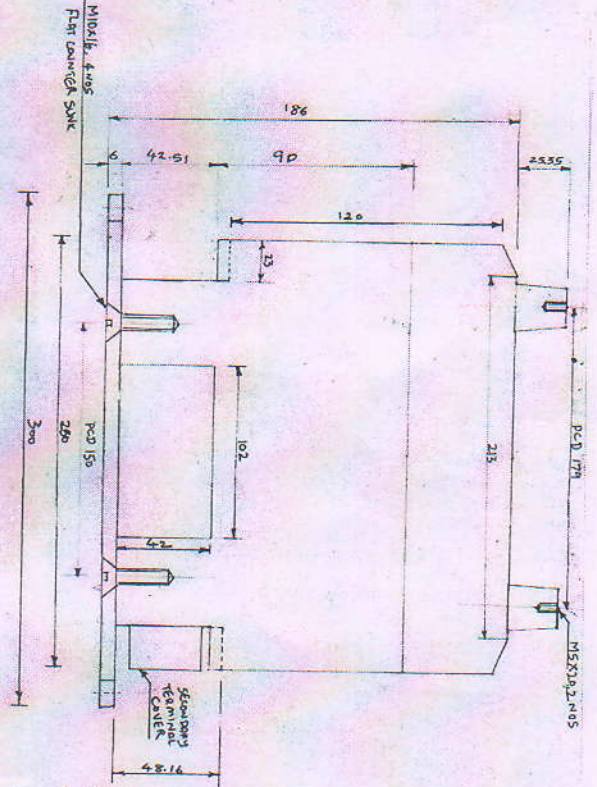
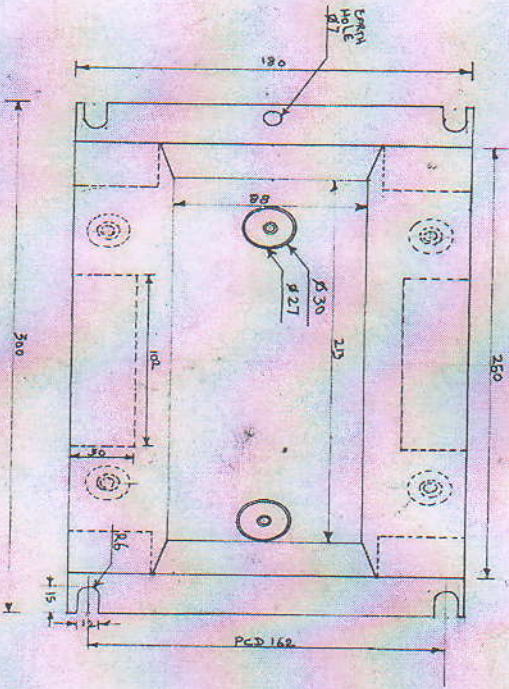

11KV POTENTIAL TRANSFORMER FOR MCC
 ALL DIMENSIONS ARE IN MM
 SCALE-1:2