



PUDUCHERRY POWER CORPORATION LIMITED

(A GOVERNMENT OF PUDUCHERRY UNDERTAKING)

PROJECT OFFICE, T.R. PATTINAM 609 606, KARAIKAL.

Phone: 04368-233060

Email: ppclmmc@gmail.com

Telefax: 04368-233355

Ref.No.AC-032/MMC/2025-26/914

GSTIN No.34AAACP6507E1ZS

Dt. 14.08.2025

ENQUIRY

To

Sub: Inviting offer for the replacement of Existing Sheds for both Boiler feed pump Motor I & II- Reg.

QUOTATION TO BE:

Submitted on or before: - 28.08.2025 – 5 pm	Opened on: 29.08.2025– 3 pm
Kept valid for 3 months from the date of opening	Submitted in ONE part.

Sealed quotation is invited for the replacement of Existing Sheds for both Boiler feed pump Motor I & II as per the enclosed **scope of work** and the terms & conditions are mentioned therein.

General Terms and conditions:

1. The rate quoted should be inclusive of providing manpower, material, transport charges, tools and tackles, etc. required for the works, GST/ESI/EPF all taxes and other charges as admissible.
2. Applicable other charges, if any should be clearly mentioned. If not mentioned, it will be presumed that the rate quoted is inclusive of all other charges.
3. The L1 rate shall be selected by considering the lowest of total offered value.
4. The work should be carried out in PPCL site, T.R.Pattinam, Karaikal 609 606. **As per the scope of the work are enclosed.**
5. No Workshop facility is available inside PPCL campus and outside private workshops to be utilized by the party concerned at their own cost.
6. Exact date for commencement of work will be intimated appropriately and the work has to be completed as per the directions of the Engineer-in-charge.
7. Necessary Gate pass should be obtained well before the commencement of work.
8. The party should ensure round the clock progress of work at site and should follow all safety rules and procedures strictly inside the plant.
9. In case of any faulty workmanship in the scope of work, the tenderer must rectify the same on free of Cost.
10. **PAYMENT: 80%** Payment will be made within 30 days from the date of receipt of your invoice after completion of work satisfactorily and approval of Engineer-in-charge and the balance **20%** Payment will be made after submission of ESI / EPF etc. documents.
11. **The bill in triplicate along with advance stamped receipt should be sent to the undersigned for effecting payment.**



PUDUCHERRY POWER CORPORATION LIMITED

(A GOVERNMENT OF PUDUCHERRY UNDERTAKING)

PROJECT OFFICE, T.R. PATTINAM 609 606, KARAİKAL.

Phone: 04368-233060

Email: ppclmmc@gmail.com

Telefax: 04368-233355

Ref.No.AC-032/MMC/2025-26/914

GSTIN No.34AAACP6507E1ZS

Dt. 14.08.2025

ENQUIRY PAGE - 2



12. The bidder shall make payments for ESI & EPF in separate code number other than PPCL code. No permission shall be given for PPCL code. If the party fails to arrange the ESI/EPF Code, the contract will be cancelled
13. The **20%** Payment will be made only after submission of the following :
 - **For EPF:**

To be generated from the EPF website for the specific month for the manpower deployed to PPCL and the same to be enclosed separately with a covering letter.

 - i. Combined challan of account no.01, 02, 10, 21 &22 with TRRN number.
 - ii. EPF-Electronic Challan cum Return (ECR)
 - iii. EPF Challan summery/EPF-TRRN details.
 - **For ESI:**

To be generated from the ESI website for the specific month for the manpower deployed to PPCL and the same to be enclosed separately with a covering letter.

 - i. ESI challan number
 - ii. ESI monthly contribution –online challan status (Transaction details)
 - iii. ESI monthly contribution (Contractor wise) for the month of.....
14. Party should obtain all permits and licenses under the laws or regulations applicable and in connection with the work carried out and shall comply with and discharge all statutory obligations/liabilities under the various laws such as Factory Act/Workmen's Compensation Act /Employee's State Insurance Act / Employee's Provident Fund Act / Payment of Wages Act / Contract Labour (Regulation & Abolition) Act / Minimum Wages Act Etc., or any modification thereof.
15. Sealed quotations should be superscripted as "**QUOTATION/ENQUIRY NO. AC-032**" for the replacement of Existing Sheds for both Boiler feed pump Motors I & II" and to be sent to **The Executive Engineer (Mech.), Puducherry Power Corporation Limited, T.R.Pattinam, Karaikal-609606.**
16. Our Tax payment Identification **GSTIN No.34AAACP6507E1ZS** is registered with Commercial Taxes Department, Puducherry. Bidder should furnish their GST details.
17. The undersigned reserves all rights to accept/reject any or all the quotations without assigning any reasons thereof.
18. The work order is not transferable and subcontract/sublet of work is not permitted.

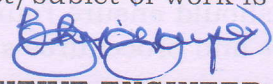
EXECUTIVE ENGINEER (MECH)-PLANT



PUDUCHERRY POWER CORPORATION LIMITED

(A GOVERNMENT OF PUDUCHERRY UNDERTAKING)

PROJECT OFFICE, T.R. PATTINAM 609 606, KARAIKAL.

Phone: 04368-233060

Email: ppclmmc@gmail.com

Telefax: 04368-233355

Ref.No.AC-032/MMC/2025-26/914 GSTIN No.34AAACP6507E1ZS

Dt. 14.08.2025

ENQUIRY PAGE - 3

S1 No	Description	No of Shed	Unit Rate	Total Rate (In Rs)
1	Charges for the replacement of Existing Sheds for both Boiler feed pump Motors I & II as per the enclosed scope of work (Inclusive of Manpower, Material, Tools, transport, TA-DA and ESI/EPF)	02 No's		
Sub Total Amount (Rs.)				
GST @ % for Works				
Total Amount (Rs.)				

SCOPE OF WORK FOR PROVIDING SHEDS FOR BFP MOTOR

1. Removal of existing damaged shed and shifting to PPCL scrap yard.
2. Supply of required 2" inch GI pipe, 1.5 X 1.5 square tube, GI sheets, consumables.
3. Necessary fabrication of frame work for shed which includes necessary cutting, welding and fixing in position.
4. The contractor should deploy essential manpower and should complete the work in single sitting.
5. Necessary welding machine, cutting set, cutting machine, other tools & tackles. Consumables, paints and safety equipments are under contractor's scope.
6. The sheds to be provided is to have wheel arrangements so that it can be moved during maintenance works.
7. Applying one coat of metal primer and two coat of smoke grey paint.
8. After completion the contractor should make the place neat and cleaning etc. as directed by the Engineer-in-charge.
9. The party may visit the site before submitting the offer.

Commercial Terms and Condition:

S1. No	Details	Terms in Enquiry	Terms Accepted by the Party
1	Price Quoted	Inclusive of manpower, Material, transport charges, GST and ESI/EPF applicable taxes and other charges.	
2	Payment Terms	80% Payment within 30days after work completion and balance 20% after submission of ESI & EPF documents	
3	Validity	90 Days from date of opening	
4	Delivery/Completion Period	To be completed as per the directions of the Engineer-in-charge.	
5	Acceptance of All the Terms and Condition of the Enquiry	To be Accepted	

Signature with Seal of the Party

Providing new sheds for both boiler feed pump motor I & II

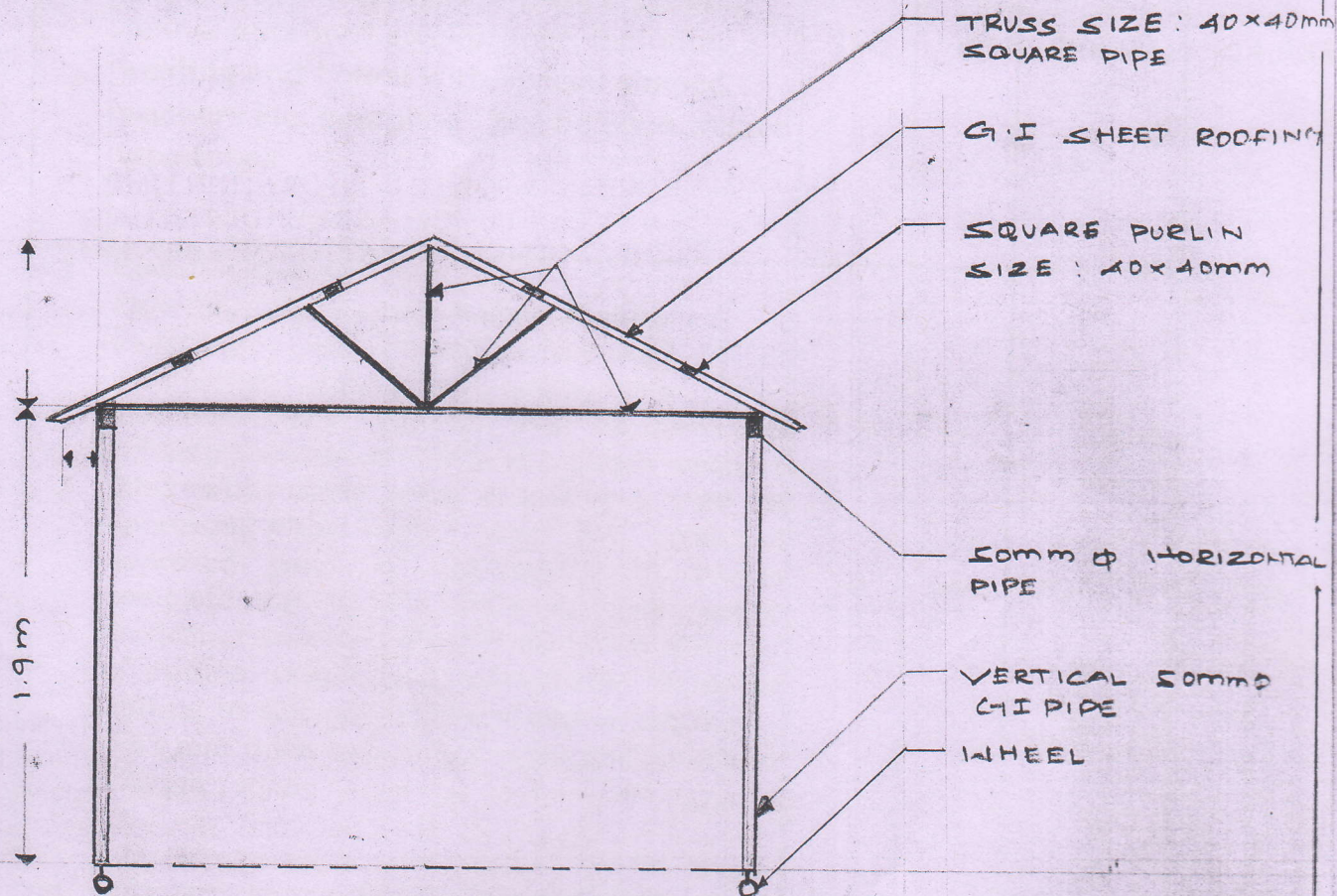

ELEVATION

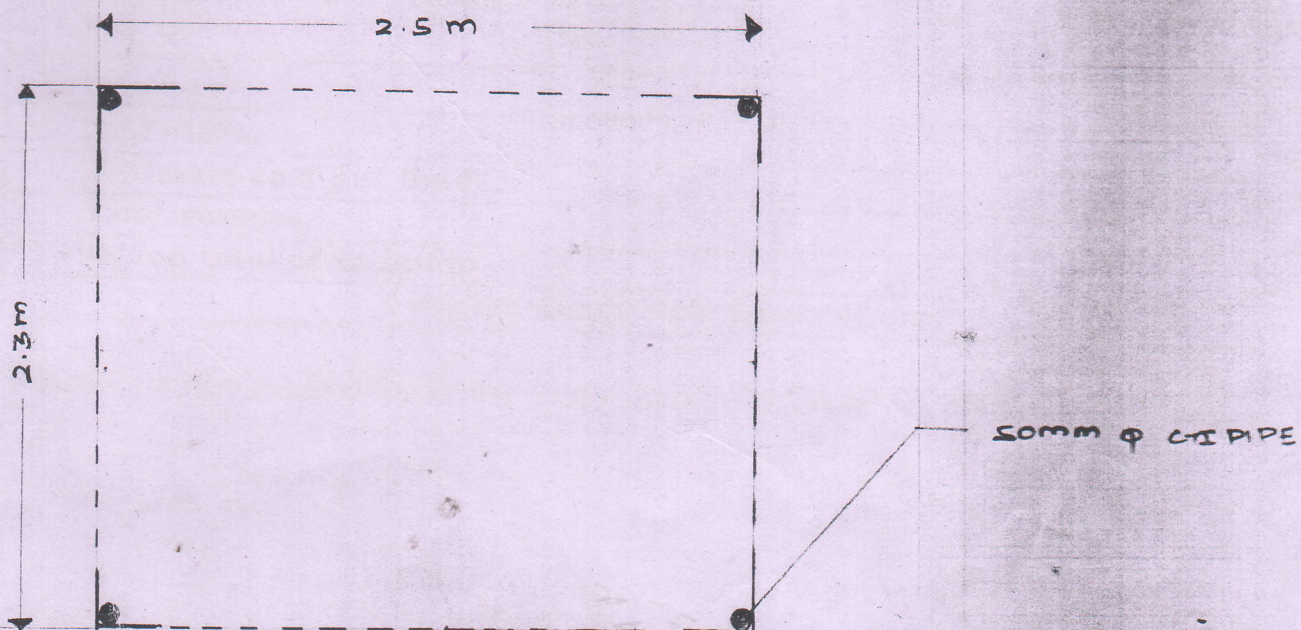

PLAN